



NRSE Series
SMD Shielded Tiny Power Inductor
Size 8040

CHARACTERISTICS

-
-

APPLICATION

-
-

Dimensions: [mm]

Land Pattern: [mm]

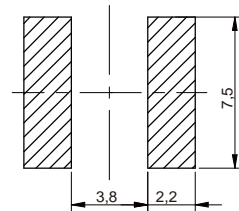

Electrical Properties:

	5
	8
5.65	
	24
	28
	35
	37
	45
	56
	58
	74
	±30% 1 T1



Part No	(μ H)	Tolerance	Satura on (A)	Temperature Rise (A)	(m)	Condi on
	68					
	82				245	
					538	

° °

°

Typical Electrical Characteristics:

Inductance VS. Current Characteristics:



Temperature Rise VS. Current Characteristics:

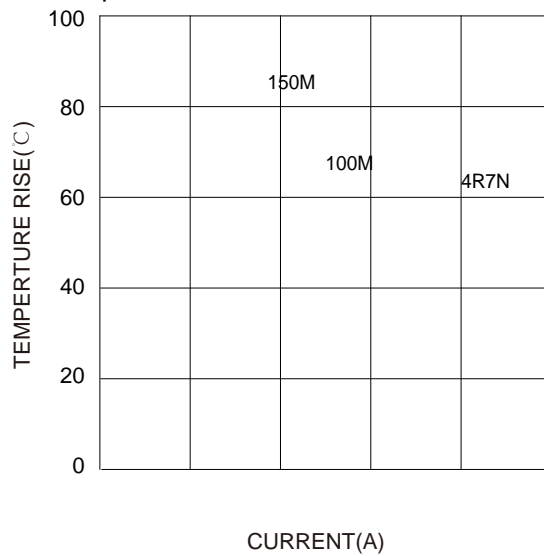



Soldering Reflow:

Preheat condition: 160 ~180 °C / 160 sec.

Allowed time above 220 °C : 50 sec.

Max temperature: 250 °C .

Packaging Information:

Tape Dimension :

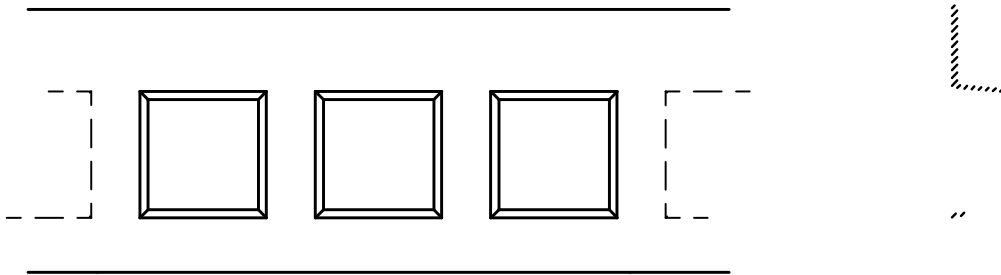

Series	A0 (mm)	B0 (mm)	D (mm)	P0 (mm)	P1 (mm)	W (mm)	K0 (mm)	E (mm)	T (mm)
@DE7* " &"	+ž&" f " ž#	+ž&" f " ž#	#ž " f " ž#	&ž" " f " ž#	#\$ž" " f " ž#	#(ž" " f " ž%	&ž&" f " ž#	#ž)' f " ž#	" ž&" f " ž'

Peel force of top cover tape:

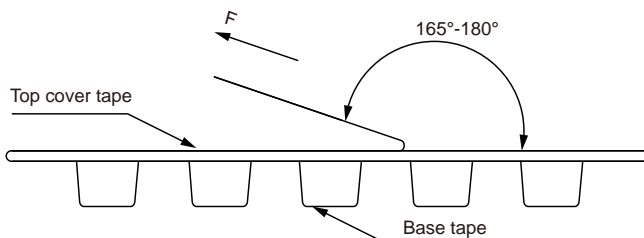

FZWbWVYadJMaXfab UahWifSbWeZS^TWTWfi WVV " ž" %fa " ž+* @



Reel Dimension: [mm]

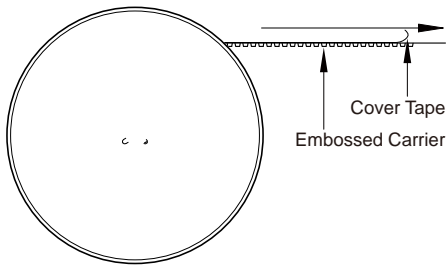

Packaging Quantity: